

Gooseneck Kettle

1.0 L DIGITAL VARIABLE TEMPERATURE

bonavita



Model:
BV382510VCEV
BV382510VCEB
BV382510VAUS

Technical Data:

Rated current: **4.3 A**

Rated power input: **1000 W**

Rated voltage:

AC 220-240 V, 50/60 Hz

1 year limited warranty

Bonavita.life

Customer Service:

**Please contact the retailer which
you purchased your product**

USA 1-888-850-2675

Support@Bonavita.life

EU 05331-67948-60

support@bestbrew.de

UK 020-7635-6247

hello@coffeehit.co.uk

AU +61-2-49526498

sales@bomborasupplies.com.au

TABLE OF CONTENTS

SAFEGUARDS

Important Safeguards	4
Extension Cords	6

WARRANTY

Limited Warranty	7
------------------------	---

INSTRUCTIONS

Operating Your Kettle	9
Setting the Temperature	10
Count Up Timer	11
Brewing Temperature Chart	12
Cleaning Your Appliance	13
Pour-Over Manual Brew Coffee	14

PRODUCT CARE & TROUBLESHOOTING

Correct Disposal	15
Kettle Troubleshooting	15

IMPORTANT SAFEGUARDS

This appliance is for household use only. When using electrical appliances, basic safety precautions should always be followed to avoid fires, electric shocks, burns, or other injuries and damage. Read these operating and safety instructions carefully. Call our toll-free customer service number for information on examination, repair, and adjustments; do not attempt to repair the appliance yourself.

Read all instructions.

- Do not touch hot surfaces - use the handles or knobs.
- To disconnect the appliance, first turn the power switch off, then remove plug from the wall outlet.
- Unplug from outlet when not in use and before cleaning. Allow to cool before putting on or taking off parts, and before cleaning the appliance.
- The use of accessory attachments is not recommended by the appliance manufacturer and may result in fire, electrical shock or personal injury.
- Do not use outdoors or in damp areas.
- Do not let the cord hang over the edge of a table or counter.
- Do not place appliance on or near a hot electric or gas burner, or in a heated oven.
- Do not use this appliance for anything other than its intended use.
- Place the appliance on a flat level surface.
- Always pour slowly to avoid scalding and burns.
- Only fill with non-carbonated water. Never fill with milk or any other type of liquid.
- Do not touch hot surfaces. Use handles or knobs.
- To protect against fire, electric shock and injury to persons, do not place cord, plugs, or appliance in water or other liquid.
- Do not attempt to operate the appliance without putting water in kettle. Only fresh, cold water should be used in the kettle. Do not use hot water.
- Do not fill above the 'max' indicator inside the kettle. If the kettle is overfilled, hot water may be ejected.
- Do not set a hot kettle on a wet or cold surface.

- If kettle sustains an impact it may be damaged. Check for cracks, damage or signs of leakage before using.
- Do not use a base unit other than the one supplied. The use of accessory attachments is not recommended by the appliance manufacturer and may result in fire, electrical shock or personal injury.
- Make sure that the voltage in your home corresponds with the voltage indicated on the bottom of the appliance.
- Do not attempt to operate the appliance if it only works intermittently, or stops working altogether.
- Do not operate any appliance with a damaged cord or plug or after the appliance malfunctions or has been damaged in any manner. Return appliance to an authorized service facility for examination, repair or adjustment.
- Scalding may occur if the lid is removed during heating.
- To avoid circuit overload, do not operate another high wattage appliance on the same circuit.
- Always remove kettle from base before filling. Remove all moisture on the bottom of the kettle before placing it onto the power base.
- Be aware of steam being emitted from spout or lid especially during refilling. Do not remove lid during heating cycle. Scalding may occur if the lid is removed during heating cycles.
- Do not insert any object into slots or holes of the kettle.
- This appliance is not intended for use by persons (including children) with reduced physical, sensory or mental capabilities, or lack of experience and knowledge, unless they have been given supervision or instruction concerning use of the appliance by a person responsible for their safety.
- This appliance can be used by children aged from 8 years and above if they have been given supervision or instruction concerning use of the appliance in safe way and if they understand the hazards involved. Cleaning and user maintenance shall not be made by children unless they are older than 8 and supervised. Keep the appliance and its cord out of reach of children age less than 8 years.

SAVE THESE INSTRUCTIONS!

EXTENSION CORDS

A short power-supply cord is provided to reduce the risk of tangling and tripping. Longer detachable power-supply cords or extension cords may be used if care is exercised. If a detachable power-supply cord or extension cord is used:

- The electrical rating of the extension cord should be appropriate for the electrical rating of the appliance.
- The longer cord should be arranged so that it will not drape over the counter top or tabletop where it can be tripped over, snagged, or pulled on, especially if children are present.

Limited Warranty

1 year limited warranty from the date of original purchase.

Warranty valid only in U.S. & Canada. For Warranty outside of U.S. & Canada please contact the retailer from which you purchased your product.

1. This warranty extends only to the original retail purchaser or gift recipient. Keep the original sales receipt, as proof of purchase is required to make a warranty claim.
2. Defects that occurred due to improper connection, improper handling, or repair attempts by non-authorized persons are not covered by the warranty. The same applies for failure to comply with the use of consumables (e.g. cleaning and decalcifying agents) that do not correspond to the original specifications.
3. This device was designed and built for household use only. It is not suited for other uses.
4. Damages which are not the responsibility of the manufacturer are not covered by the warranty. This is valid especially for claims arising from improper use (e.g. operation with insufficient current or improper voltage).
5. The guarantee becomes void if repairs are carried out by third parties not authorized by the manufacturer and/or if spare parts are used other than the original ones.

Please according to the below detail service information for warranty claim:

USA 1-888-850-2675

Support@Bonavita.life

EU 05331-67948-60

support@bestbrew.de

UK 020-7635-6247

hello@coffeehit.co.uk

AU +61-2-49526498

sales@bomborasupplies.com.au

Product Features

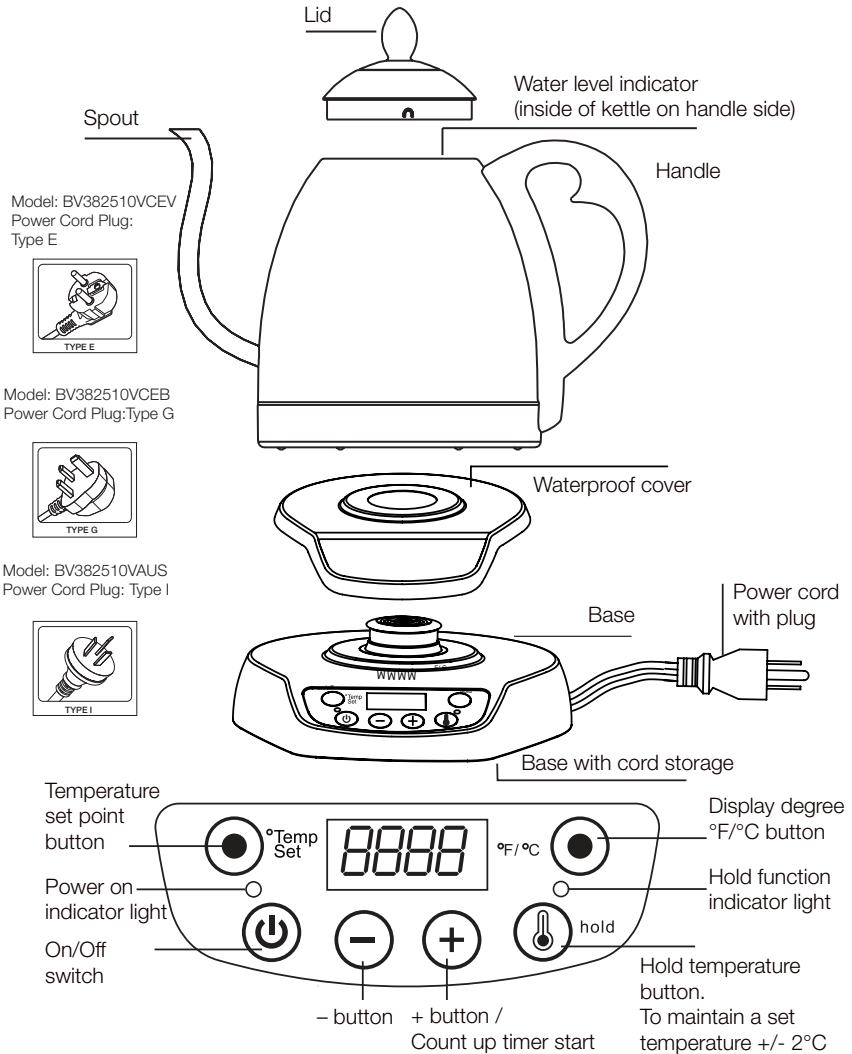

Technical Data:

Rated current: **4.3 A**

Rated power input: **1000 W**

Rated voltage:

AC 220-240 V, 50/60 Hz

Capacity: **Max.33.8Oz (1.0L)**

Operating Your Kettle

Before plugging the kettle into the wall outlet, check that the electrical circuit is not overloaded with other appliances.

SETTING UP THE KETTLE:

1. Set the base on a flat, even and steady surface.
2. Remove the kettle from the base. Place the waterproof cover on top of base. (ill. A)
3. Take off the lid. Fill the kettle with cold water (ill. B). Do not fill over the 'max' indicator marking.
4. After filling the kettle with water, insert the lid into kettle with holes facing towards handle. Plug the power cord into the standard wall outlet. (ill. C)
5. Put the kettle firmly on the base and press the on/off button. The power on indicator light will turn on. The display flashes the set temperature for 3 seconds. (ill. D)

The factory default temperature is 185°F (85°C)

PREPARING THE KETTLE FOR FIRST TIME USE:

1. Fill the kettle to Max fill line with cold water and then heat at the maximum temperature setting, then empty.
2. Let the appliance cool down 1 minute
3. Repeat heating cycle and rinse. Your kettle is now ready for use.

SELECTING THE DISPLAY

TEMPERATURE UNITS, °F or °C:

Press the °F/°C button to display the temperature in Fahrenheit or Celsius when the power is on.

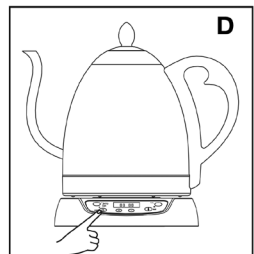
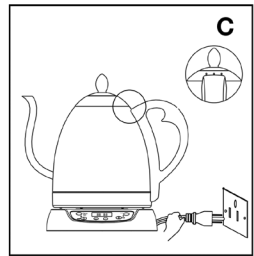
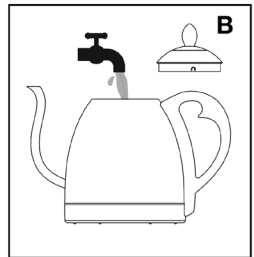
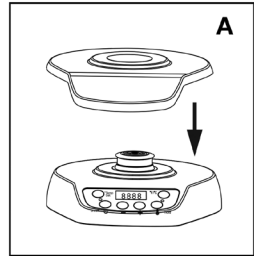

SELECTING THE PRESET TEMPERATURES

(ILL. E):

Press the temperature set button and continue to press it until your desired preset temperature is displayed.

Note: The Factory preset temperatures are: 60°C (140°F), 80°C (176°F), 85°C (185°F), 88°C (190°F), 96°C (205°F) and 98°C (208°F).

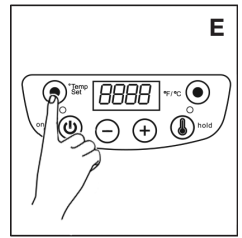

MANUALLY SETTING TEMPERATURE SET POINT

1. Press the temperature set button. The last temperature set point flashes on the display.
2. Press the + or – button to select your preferred temperature.
3. Once the display stops flashing the temperature is set and the display shows current water temperature.

Once you have set the temperature set point, it is stored in memory and will be recalled whenever you turn on the kettle. There is no need to set the temperature every time unless you want to change the set point.

During the heating cycle the LED display shows the current water temperature.

After the set temperature is reached the heater will turn off but the display will continue to show water temperature for up to 1 hour if the kettle isn't removed from the base.

If the kettle is removed from base during a heating cycle the heating cycle and power on indicator light turn off. The LED will display "0 00". When the kettle is returned to base the display will show current water temperature for 7 minutes and then turn off.

To manually interrupt the heating process, press the on/off button at any time. The heater and LED lights will turn off.

SELECTING WATER TEMPERATURE HOLD

This feature allows the kettle to reach and maintain water at a set temperature for up to one hour. This is an optional setting.

1. First select the temperature set point using above steps.
2. Press the hold button and the hold indicator LED will turn on. (ill. E).

- When set temperature is reached the heater will turn off and on as needed to maintain set temperature. The power on indicator light is on and the LED display shows the current water temperature.
- When you lift kettle to pour and return to the base, the hold button must be pressed again if you want to continue the hold temperature function. If you don't press the hold button after returning the kettle to base, the display will show current water temperature for 7 minutes and then the unit will power off.

HIGH ALTITUDE USE

At higher elevations water boils at lower temperatures. Use the graph below to set your kettle temperature.

COUNT UP TIMER FEATURE

Note: when you lift the kettle, the LED display will show the count-up timer. The first number indicates the minutes, and the last two numbers indicate the seconds (the maximum count time is 7 minutes). Press the + button to start the timer. Set the kettle back on the base and lift back off to reset timer to zero.

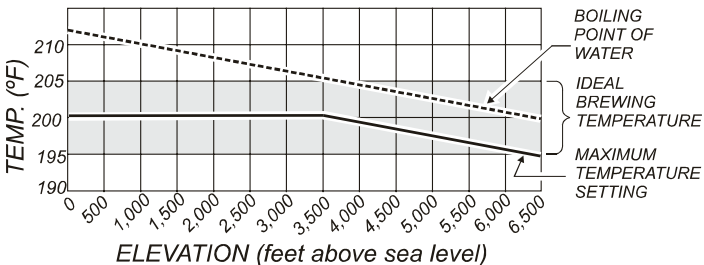
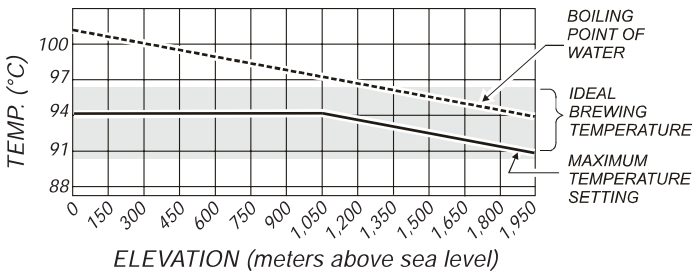

WARNING: The appliance is very hot during use. Do not touch kettle surface.
Danger of burns!

WARNING: Never leave the kettle unattended while heating water, especially if there are children nearby.

WARNING: Do not open the lid while heating water.

WARNING: Do not immerse the base or the kettle in water or any liquids. This may cause electric shock or damage the appliance.

WARNING: Be careful when handling hot water.
Danger of scalding!

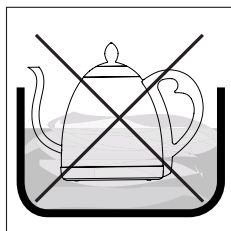
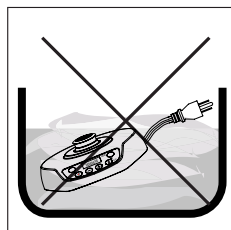

SUGGESTED BREWING TEMPERATURE CHART:

SETTING	TEMPERATURE
Coffee	200 °F (93 °C)
Green Tea	175 °F (80 °C)
White Tea	185 °F (85 °C)
Oolong Tea	190 °F (88 °C)
Black Tea/ Herbal Tea / Tea Bags	208 °F (98 °C)
Cocoa	190 °F (88 °C)

ADJUSTING KETTLE LID TENSION

If you feel the kettle lid is too hard or too easy to remove from the kettle, please follow the steps below to adjust the tension:

1. Take the lid off the kettle.
2. Use a small screwdriver to adjust the three tabs of the kettle lid.
If you push in the tab, the lid tension will be lessened and easier to push on and off. If you pull out the tabs the lid will be harder to pull off.
3. Adjust the tabs, replace the lid and remove it to see if the adjustment is correct.
4. Repeat the step 2 and 3 until you have adjusted the lid to your preference.



Cleaning Your Appliance

- Unplug the appliance and allow kettle to cool down before cleaning.
- Clean the outside of the appliance, including the base with a soft damp cloth.
- Clean the inside of the kettle regularly with a mild dish cleanser or descaler.
- Do not use abrasive cleansers.
- After cleaning, dry the kettle and the base thoroughly.

When mineral scale builds up in your kettle, it can affect temperature consistency and slow down heating time. To ensure optimum performance, Bonavita recommends descaling the kettle when mineral build-up is visible inside the kettle.

Note: Vinegar may not effectively descale the kettle and can be difficult to thoroughly rinse. Vinegar may also leave behind an odor that could affect future uses. Bonavita recommends using a descaler.

HOW TO USE DESCALER:

1. Follow the instructions on the descaler.
2. Pour into kettle.
3. Bring solution to boil.
4. Let vessel cool for 15 minutes, then discard solution.

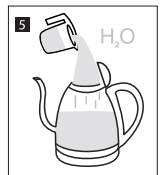
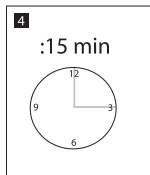
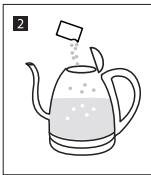

5. Rinse thoroughly with fresh water.

STORAGE

Clean and dry the appliance before storing. Store the kettle in its box or in a clean, dry place. Never wrap the power cord around the kettle. Always use the cord storage on the bottom of the base.

Pour-Over Manual Brew Coffee

Pour-over, or manual brew coffee preparation is a great way to control your coffee quality.

It does require more time than just flipping a switch, but for many the higher level of engagement is part of the pleasure of consuming coffee.

Equipment needed:

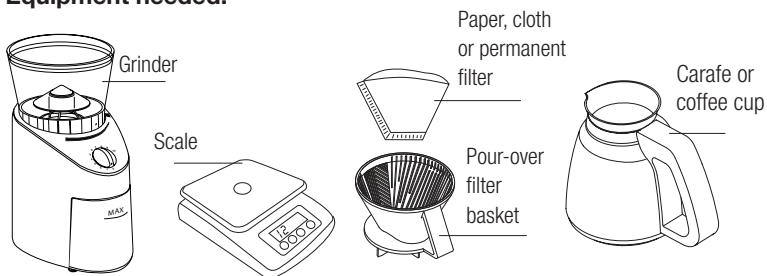

Brewing manual pour-over method:

- Measure 6 ounces of water for each cup you intend to brew. Place measured water in kettle and turn on kettle to heat the water to your desired set temperature.
- Grind two tablespoons of coffee beans per cup.
- Rinse the filter cone, filter, and coffee pot (or whatever you are brewing into) with hot water to preheat them.
- Assemble the filter cone, filter and vessel.
- Once the water reaches the set point pour it into the filter. We recommend starting in the center and pouring in a circular pattern, moving gradually towards the edge of the coffee bed. A slow steady pour allows for even extraction.

Tips:

- We recommend preheating the filter and cone. Pour a couple of ounces ~60ml of hot water into the filter and discard prior to adding coffee.
- If you have access to a scale you can measure the amount of water while pouring.
- Pre-wetting the coffee grounds a minute before starting to pour-over helps extraction.

- Pour-over coffee is ground finer than drip, but not as fine as espresso.

Correct Disposal of this Product

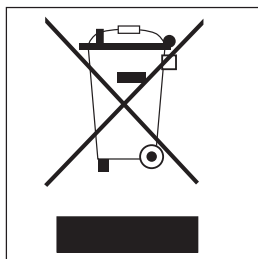

This marking indicates that this product should not be disposed with other household wastes throughout the EU. To prevent possible harm to the environment or human health from uncontrolled waste disposal, recycle it responsibly to promote the sustainable reuse of material resources. To return your used device, please use the return and collection systems or contact the retailer where the product was purchased. They can take this product for environmental safe recycling.

Kettle Troubleshooting

PROBLEM	SOLUTION
Kettle never reached more than 93° C	If you are at an elevation of 3000 feet or higher, this is normal as water boils at a much lower temperature of 93°C (199°F). If you are below 3000 feet, you may have a defective kettle. Please contact the retailer from which you purchased your product.
Minimum amount of water you can boil in kettle	10 ounces (300ml) is the least amount of water recommended to boil in the 1L electric kettle.
Discolored spots have appeared on my kettle	Descale your kettle with a high-quality descaler
Clicking sound while heating	The clicking is an electrical relay that regulates the temperature of the water

For other tips and answers to frequently asked questions, please visit Bonavita.life/Kettle-FAQ

